

CONSTRUCTION PLANS
FOR
EAST KAPOLEI II
DETENTION BASIN RESTORATION
(DPP SUBD. FILE NO. 2008 / SUB-21)
HONOULIULI, EWA, OAHU, HAWAII

OWNER & DEVELOPER: DEPARTMENT OF HAWAIIAN HOME LANDS
TAX MAP KEY: 9-1-17: 110

cp&e Community Planning and Engineering, Inc.
Engineering Design | Construction Management | Infrastructure Planning
1286 Queen Emma Street Honolulu, Hawaii

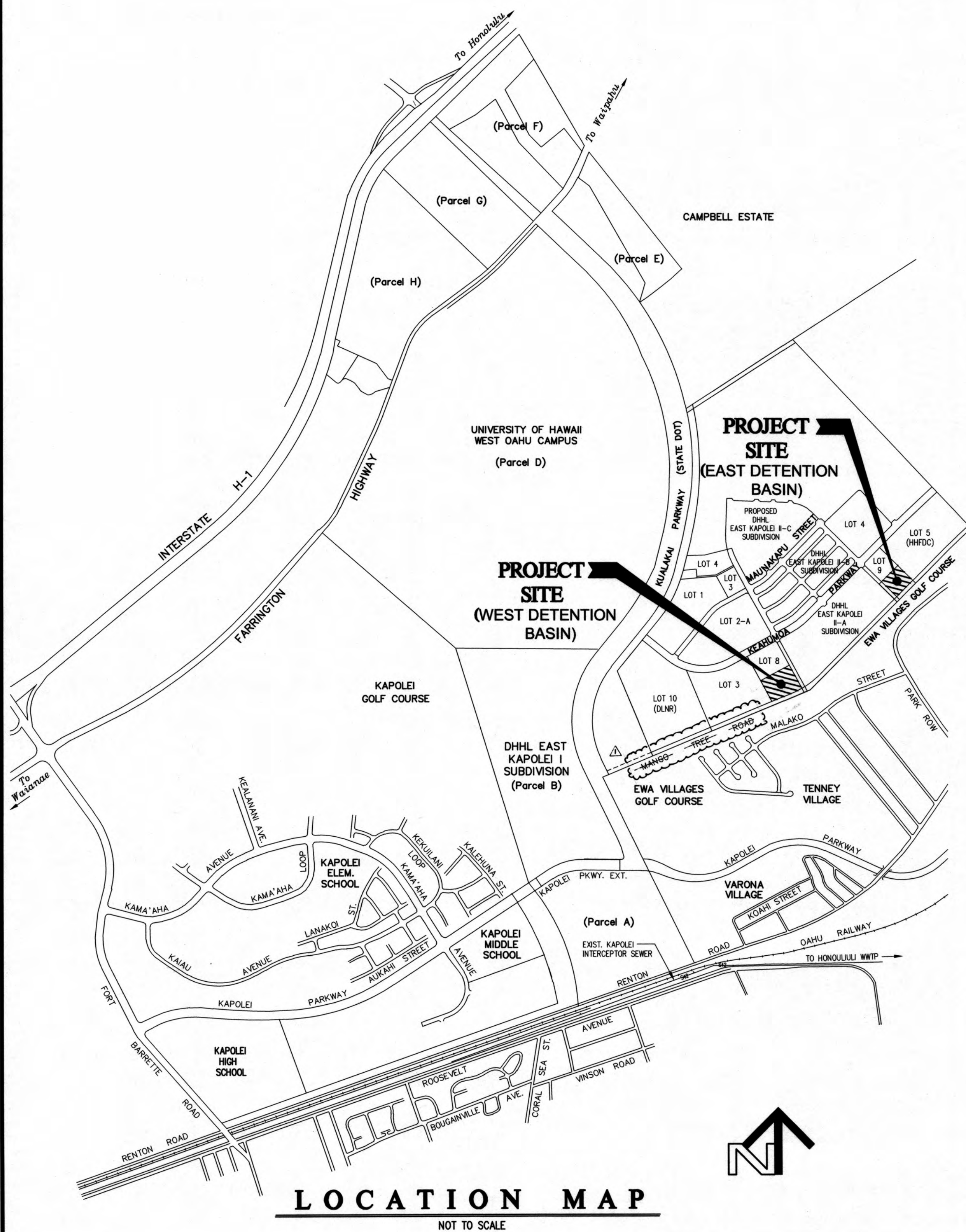

INDEX TO DRAWINGS

SHEET NO.	DWG. NO.	DESCRIPTION
1	T-1	TITLE SHEET
2	C-1	GENERAL NOTES
3	C-2	GENERAL LAYOUT PLAN
4	C-3	RESTORATION PLAN - WEST DETENTION BASIN
5	C-4	RESTORATION PLAN - EAST DETENTION BASIN
6	C-5	CROSS SECTIONS - WEST DETENTION BASIN
7	C-6	CROSS SECTIONS - EAST DETENTION BASIN
8	C-7	EROSION AND SEDIMENT CONTROL PLAN
9	C-8	EROSION AND SEDIMENT CONTROL NOTES
10	C-9	MISCELLANEOUS DETAILS

APPROVED

[Signature] 5/24/14
CHAIRMAN, HAWAIIAN HOMES COMMISSION
DEPARTMENT OF HAWAIIAN HOME LANDS
STATE OF HAWAII
DATE

[Signature] 5/25/18
DIRECTOR, DEPARTMENT OF PLANNING AND PERMITTING
CITY & COUNTY OF HONOLULU
(FOR SITE GRADING ONLY)
DATE

[Signature] 4/8/2022
DIRECTOR, DEPARTMENT OF PLANNING AND PERMITTING
CITY & COUNTY OF HONOLULU
(FOR SITE GRADING ONLY)
(FOR RE-APPROVAL DUE TO TIME LAPSE)
DATE

GRADING NOTES

1. ALL GRADING WORK SHALL BE IN ACCORDANCE WITH CHAPTER 14, ARTICLES 13, 14, 15 AND 16, AS RELATED TO GRADING, SOIL EROSION AND SEDIMENT CONTROL, OF THE REVISED ORDINANCES OF HONOLULU, 1990, AS AMENDED.
2. NO CONTRACTOR SHALL PERFORM ANY GRADING OPERATION SO AS TO CAUSE FALLING ROCKS, SOIL, OR DEBRIS IN ANY FORM TO FALL, SLIDE OR FLOW ONTO ADJOINING PROPERTIES, STREETS OR NATURAL WATERCOURSES. SHOULD SUCH VIOLATIONS OCCUR, THE CONTRACTOR MAY BE CITED AND THE CONTRACTOR SHALL IMMEDIATELY MAKE ALL REMEDIAL ACTIONS NECESSARY.
3. THE CONTRACTOR, AT HIS OWN EXPENSE, SHALL KEEP THE PROJECT AREA AND SURROUNDING AREA FREE FROM DUST NUISANCE. THE WORK SHALL BE IN CONFORMANCE WITH THE AIR POLLUTION CONTROL STANDARDS CONTAINED IN THE HAWAII ADMINISTRATIVE RULES, TITLE 11, CHAPTER 60.1, "AIR POLLUTION CONTROL".
4. THE UNDERGROUND PIPES, CABLES OR DUCTLINES KNOWN TO EXIST BY THE ENGINEER FROM HIS SEARCH OF RECORDS ARE INDICATED ON THE PLANS. THE CONTRACTOR SHALL VERIFY THE LOCATIONS AND DEPTHS OF THE FACILITIES AND EXERCISE PROPER CARE IN EXCAVATING IN THE AREA. WHEREVER CONNECTIONS OF NEW UTILITIES ARE SHOWN ON THE PLANS, THE CONTRACTOR SHALL EXPOSE THE EXISTING LINES AT THE PROPOSED CONNECTIONS TO VERIFY THEIR LOCATIONS AND DEPTHS PRIOR TO EXCAVATION FOR THE NEW LINES.
5. ADEQUATE PROVISIONS SHALL BE MADE TO PREVENT SURFACE WATERS FROM DAMAGING THE CUT FACE OF AN EXCAVATION OR THE SLOPED SURFACES OF A FILL. FURTHERMORE, ADEQUATE PROVISIONS SHALL BE MADE TO PREVENT SEDIMENT-LADEN RUNOFF FROM LEAVING THE SITE.
6. ALL SLOPES AND EXPOSED AREAS SHALL BE SODDED OR PLANTED AS SOON AS FINAL GRADES HAVE BEEN ESTABLISHED. PLANTING SHALL NOT BE DELAYED UNTIL ALL GRADING WORK HAS BEEN COMPLETED. GRADING TO FINAL GRADE SHALL BE CONTINUOUS, AND ANY AREA WITHIN WHICH WORK HAS BEEN INTERRUPTED OR DELAYED SHALL BE PLANTED.
7. FILLS ON SLOPES STEEPER THAN 5:1 SHALL BE KEED.
8. THE CITY SHALL BE INFORMED OF THE LOCATION OF THE BORROW/DISPOSAL SITE FOR THE PROJECT WHEN THE APPLICATION FOR A GRADING PERMIT IS MADE. THE BORROW/DISPOSAL SITE MUST ALSO FULFILL THE REQUIREMENTS OF THE GRADING ORDINANCE.
9. NO GRADING WORK SHALL BE DONE ON SATURDAYS, SUNDAYS AND HOLIDAYS AT ANY TIME WITHOUT PRIOR NOTICE TO THE DIRECTOR, D.P.P., PROVIDED SUCH GRADING WORK IS ALSO IN CONFORMANCE WITH THE COMMUNITY NOISE CONTROL STANDARDS CONTAINED IN THE HAWAII ADMINISTRATIVE RULES, TITLE 11, CHAPTER 46, "COMMUNITY NOISE CONTROL".
10. THE LIMITS OF THE AREA TO BE GRADED SHALL BE FLAGGED BEFORE THE COMMENCEMENT OF THE GRADING WORK.
11. THE CONTRACTOR OF THE PROJECT SHALL BE RESPONSIBLE FOR ALL GRADING OPERATIONS TO BE PERFORMED IN CONFORMANCE WITH THE APPLICABLE PROVISIONS OF THE HAWAII ADMINISTRATIVE RULES, TITLE 11, CHAPTER 54, "WATER QUALITY STANDARDS," AND TITLE 11, CHAPTER 55, "WATER POLLUTION CONTROL," AS WELL AS CHAPTER 14 OF THE REVISED ORDINANCES OF HONOLULU, AS AMENDED. BEST MANAGEMENT PRACTICES SHALL BE EMPLOYED AT ALL TIMES DURING CONSTRUCTION.

THE CONTRACTOR OF THE PROJECT SHALL OBTAIN NATIONAL POLLUTANT DISCHARGE ELIMINATION SYSTEM (NPDES) PERMIT COVERAGE(S) FOR THE FOLLOWING:

1. STORM WATER DISCHARGES ASSOCIATED WITH CONSTRUCTION ACTIVITIES THAT DISTURB ONE ACRE OR MORE.

IN ACCORDANCE WITH STATE LAW, ALL DISCHARGES RELATED TO PROJECT CONSTRUCTION OR OPERATIONS ARE REQUIRED TO COMPLY WITH STATE WATER QUALITY STANDARDS (HAWAII ADMINISTRATIVE RULES, CHAPTER 11-54). BEST MANAGEMENT PRACTICES SHALL BE USED TO MINIMIZE OR PREVENT THE DISCHARGE OF SEDIMENT, DEBRIS, AND OTHER POLLUTANTS TO STATE WATERS. PERMIT COVERAGE IS AVAILABLE FROM THE DEPARTMENT OF HEALTH, CLEAN WATER BRANCH AT [HTTP://HEALTH.HAWAII.GOV/CWB](http://health.hawaii.gov/cwb). THE CONTRACTOR IS RESPONSIBLE FOR OBTAINING FEDERAL, STATE, OR LOCAL AUTHORIZATIONS AS REQUIRED BY LAW.

12. WHERE APPLICABLE AND FEASIBLE THE MEASURES TO CONTROL EROSION AND OTHER POLLUTANTS SHALL BE IN PLACE BEFORE ANY EARTH MOVING PHASE OF THE GRADING IS INITIATED.
13. TEMPORARY EROSION CONTROLS SHALL NOT BE REMOVED BEFORE PERMANENT EROSION CONTROLS ARE IN-PLACE AND ESTABLISHED.
14. TEMPORARY EROSION CONTROL PROCEDURES SHALL BE SUBMITTED FOR APPROVAL PRIOR TO APPLICATION FOR A GRADING PERMIT.
15. IF THE GRADING WORK INVOLVES CONTAMINATED SOIL, THEN ALL GRADING WORK SHALL BE DONE IN CONFORMANCE WITH APPLICABLE STATE AND FEDERAL REQUIREMENTS.
16. FOR BENCH MARK, SEE SHEET 3.
17. FOR NON-CITY PROJECTS, THE CONTRACTOR SHALL NOTIFY THE CIVIL ENGINEERING BRANCH, D.P.P. AT 768-8084 TO ARRANGE FOR INSPECTIONAL SERVICES AND SUBMIT TWO (2) SETS OF APPROVED CONSTRUCTION PLANS SEVEN (7) DAYS PRIOR TO COMMENCEMENT OF CONSTRUCTION WORK. FOR CITY PROJECTS, THE CONTRACTOR SHALL COORDINATE INSPECTIONAL SERVICES WITH THE RESPONSIBLE CITY AGENCY.
18. PURSUANT TO CHAPTER 6E, HRS, IN THE EVENT ANY ARTIFACTS OR HUMAN REMAINS ARE UNCOVERED DURING CONSTRUCTION OPERATIONS, THE CONTRACTOR SHALL IMMEDIATELY SUSPEND WORK AND NOTIFY THE HONOLULU POLICE DEPARTMENT, THE STATE DEPARTMENT OF LAND AND NATURAL RESOURCES-HISTORIC PRESERVATION DIVISION (692-8015). IN ADDITION, FOR NON-CITY PROJECTS, THE CONTRACTOR SHALL INFORM THE CIVIL ENGINEERING BRANCH, D.P.P. (768-8084); AND FOR CITY PROJECTS, NOTIFY THE RESPONSIBLE CITY AGENCY.
19. FOR ALL PROJECTS, WHICH WILL DISTURB ONE (1) ACRE OR MORE OF LAND, THE CONTRACTOR SHALL NOT START CONSTRUCTION UNTIL A NOTICE OF GENERAL PERMIT COVERAGE (NGPC) IS RECEIVED FROM THE DEPARTMENT OF HEALTH, STATE OF HAWAII, AND HAS SATISFIED ANY OTHER APPLICABLE REQUIREMENTS OF THE NPDES PERMIT PROGRAM. ALSO, FOR NON-CITY AND OTHER NON-GOVERNMENTAL AGENCY PROJECTS, THE CONTRACTOR SHALL PROVIDE A WRITTEN COPY OF THE NGPC TO THE PERMITTING AND INSPECTION SECTION, CIVIL ENGINEERING BRANCH, D.P.P., AT LEAST SEVEN (7) CALENDAR DAYS BEFORE THE START OF THE CONSTRUCTION. FOR CITY OR OTHER GOVERNMENTAL PROJECTS, THE CONTRACTOR SHOULD PROVIDE A WRITTEN COPY OF THE NGPC TO THE APPROPRIATE CITY DEPARTMENT OR GOVERNMENTAL AGENCY PER THEIR REQUIREMENTS.

GRADING NOTES (CONT.)

20. ALL GRADING AND CONSTRUCTION WORK SHALL IMPLEMENT MEASURES TO ENSURE THAT THE DISCHARGE OF POLLUTANTS FROM THE CONSTRUCTION SITE WILL BE REDUCED TO THE MAXIMUM EXTENT PRACTICABLE AND WILL NOT CAUSE OR CONTRIBUTE TO AN EXCEEDANCE OF WATER QUALITY STANDARDS.
21. NON-COMPLIANCE TO ANY OF THE ABOVE REQUIREMENTS SHALL MEAN IMMEDIATE SUSPENSION OF ALL WORK, AND REMEDIAL WORK SHALL COMMENCE IMMEDIATELY. ALL COSTS INCURRED SHALL BE BILLED TO THE VIOLATOR. FURTHERMORE, VIOLATORS SHALL BE SUBJECTED TO ADMINISTRATIVE, CIVIL AND/OR CRIMINAL PENALTIES.

GENERAL CONSTRUCTION NOTES

1. THE CONTRACTOR SHALL OBSERVE AND COMPLY WITH ALL FEDERAL, STATE AND LOCAL LAWS REQUIRED FOR THE PROTECTION OF PUBLIC HEALTH, SAFETY AND ENVIRONMENTAL QUALITY.
3. THE CONTRACTOR SHALL PROVIDE, INSTALL AND MAINTAIN ALL NECESSARY SIGNS, LIGHTS, FLARES, BARRICADES, MARKERS, CONES, AND OTHER PROTECTIVE FACILITIES, AND SHALL TAKE ALL NECESSARY PRECAUTIONS FOR THE PROTECTION, CONVENIENCE AND SAFETY OF THE PUBLIC.
4. THE CONTRACTOR'S ATTENTION IS DIRECTED TO THE HAWAII ADMINISTRATIVE RULES, TITLE 11, CHAPTER 46, "COMMUNITY NOISE CONTROL", IN WHICH MAXIMUM ALLOWABLE NOISE LEVELS HAVE BEEN SET. IF THE CONSTRUCTION ACTIVITIES FOR THIS PROJECT WILL EXCEED THE ALLOWABLE NOISE LEVELS, THE CONTRACTOR WILL BE REQUIRED TO OBTAIN A PERMIT FROM THE DIRECTOR OF THE DEPARTMENT OF HEALTH, STATE OF HAWAII. THE CONTRACTOR SHALL OBTAIN A COPY OF CHAPTER 46 AND BECOME FAMILIAR WITH THE NOISE LEVEL RESTRICTIONS AND THE PROCEDURES FOR OBTAINING A PERMIT FOR CONSTRUCTION ACTIVITIES.
5. CONTRACTOR TO PROVIDE AS-BUILT DRAWINGS.
6. FOR BENCH MARK, SEE SHEET 3.
7. FOR PROJECTS ABUTTING STATE HIGHWAYS' RIGHTS-OF-WAY, THE OWNER OR HIS AUTHORIZED REPRESENTATIVE SHALL NOTIFY THE STATE DEPARTMENT OF TRANSPORTATION, HIGHWAYS DIVISION, OAHU DISTRICT, DRAINAGE DISCHARGE UNIT AT 831-6793 FOR AN ASSESSMENT OF STATE HIGHWAYS PERMIT REQUIREMENTS.
8. ALL EXISTING UTILITIES WHETHER OR NOT SHOWN ON THE PLANS SHALL BE PROTECTED AT ALL TIMES BY THE CONTRACTOR DURING CONSTRUCTION AND ANY DAMAGE TO THEM SHALL BE REPAIRED AND PAID FOR BY THE CONTRACTOR.
9. VERIFY AND CHECK ALL DIMENSIONS AND DETAILS SHOWN ON THE DRAWINGS PRIOR TO THE START OF CONSTRUCTION. ANY DISCREPANCY SHALL BE IMMEDIATELY BROUGHT TO THE ATTENTION OF THE DESIGNER FOR CLARIFICATION.
10. THE LOCATION AND DEPTH OF EXISTING UTILITIES WHETHER OR NOT SHOWN ON THE PLANS SHALL BE VERIFIED BY THE CONTRACTOR. EXERCISE PROPER CARE WHEN EXCAVATING IN THE AREA AND PROTECT EXISTING UTILITIES AT ALL TIMES DURING CONSTRUCTION. ANY DAMAGE TO THEM SHALL BE REPAIRED AND PAID FOR BY THE CONTRACTOR.
11. THE CONTRACTOR SHALL NOTIFY ALL AGENCIES TO VERIFY THE ACTUAL LOCATION OF ALL UTILITIES IN THE PROJECT AREA PRIOR TO EXCAVATING. THE CONTRACTOR SHALL COORDINATE ALL WORK.
12. HOURS OF OPERATIONS SHALL BE MONDAY THROUGH FRIDAY FROM 7:30 AM TO 3:30 PM. NO WORK SHALL BE DONE ON SATURDAYS, SUNDAYS AND HOLIDAYS AT ANY TIME WITHOUT PRIOR NOTICE TO THE DIRECTOR, DPP AND THE OWNER. ANY OVERTIME WORK SHALL BE IN CONFORMANCE WITH THE HAWAII ADMINISTRATIVE RULES (HAR) 11-43, "COMMUNITY NOISE CONTROL FOR OAHU".
13. THE CONTRACTOR AGREES THAT HE SHALL ASSUME SOLE AND COMPLETE RESPONSIBILITY FOR THE JOB SITE CONDITIONS DURING THE COURSE OF CONSTRUCTION OF THIS PROJECT, INCLUDING THE SAFETY OF ALL PERSONS AND PROPERTY; THAT THIS REQUIREMENT SHALL APPLY CONTINUOUSLY AND NOT BE LIMITED TO NORMAL WORKING HOURS; AND THAT THE CONTRACTOR SHALL DEFEND, INDEMNIFY AND HOLD THE OWNER AND ENGINEER HARMLESS FROM ANY AND ALL LIABILITY, REAL OR ALLEGED, IN CONNECTION WITH THE PERFORMANCE OF WORK ON THIS PROJECT, EXCEPTING FOR LIABILITY ARISING FROM THE SOLE NEGLIGENCE OF THE OWNER OR THE ENGINEER.
14. TOPOGRAPHIC SURVEY WORK WAS CONDUCTED IN NOVEMBER 2016 BY ENGINEERS SURVEYORS HAWAII, INC. VERTICAL DATUM IS REFERENCED TO MEAN SEA LEVEL. ELEVATION TAKEN FROM CITY AND COUNTY STREET MONUMENT AT INTERSECTION OF KEAHUMOA PARKWAY AND MAWEKE STREET.

ARCHAEOLOGICAL NOTE

IF DURING CONSTRUCTION, ANY PREVIOUSLY UNIDENTIFIED SITES OR REMAINS (SUCH AS ARTIFACTS, SHELL, BONE, OR CHARCOAL DEPOSITS, HUMAN BURIALS, ROCK OR CORAL ALIGNMENTS, PAVINGS, OR WALLS) ARE ENCOUNTERED, THE APPLICANT SHALL STOP WORK AND CONTACT THE STATE DEPARTMENT OF LAND AND NATURAL RESOURCES HISTORIC SITES OFFICE AT 692-8015 IMMEDIATELY. WORK IN THE IMMEDIATE AREA SHALL BE STOPPED UNTIL THE OFFICE IS ABLE TO ASSESS THE IMPACT AND MAKE FURTHER RECOMMENDATIONS FOR MITIGATIVE ACTIVITY.



THIS WORK WAS PREPARED BY ME OR UNDER MY SUPERVISION. CONSTRUCTION OF THIS PROJECT WILL BE UNDER MY OBSERVATION. LICENSE EXPIRATION DATE: 04/30/26

REVISION DATE	DESCRIPTION	MADE BY	APPROVED
9-30-22	RE-APPROVAL DUE TO TIME LAPSE	CPE	

Community Planning and Engineering, Inc.
Engineering Design | Construction Management | Infrastructure Planning
1286 Queen Emma Street Honolulu, Hawaii

EAST KAPOLEI II
DETENTION BASIN RESTORATION
(DPP SUBD, FILE NO. 2008/SUB-21)
HONOLULU, EWA, OAHU, HAWAII
OWNER & DEVELOPER: DEPARTMENT OF HAWAIIAN HOME LANDS
TAX MAP KEY: 9-1-17: 110

GENERAL NOTES

DRAWN BY: MFM	ENGINEER: SES	CHECKED BY: AMM
---------------	---------------	-----------------

APPROVED: *Melvin S. Johnson* 4/4/22
CHIEF, CIVIL ENGINEERING BRANCH, D.P.P. DATE
(FOR RE-APPROVAL DUE TO TIME LAPSE)

Melvin S. Johnson 5/17/22
CHIEF, CIVIL ENGINEERING BRANCH, D.P.P. DATE

FILE	POCKET	FOLDER	NO.
------	--------	--------	-----

FILE	POCKET	FOLDER	NO.

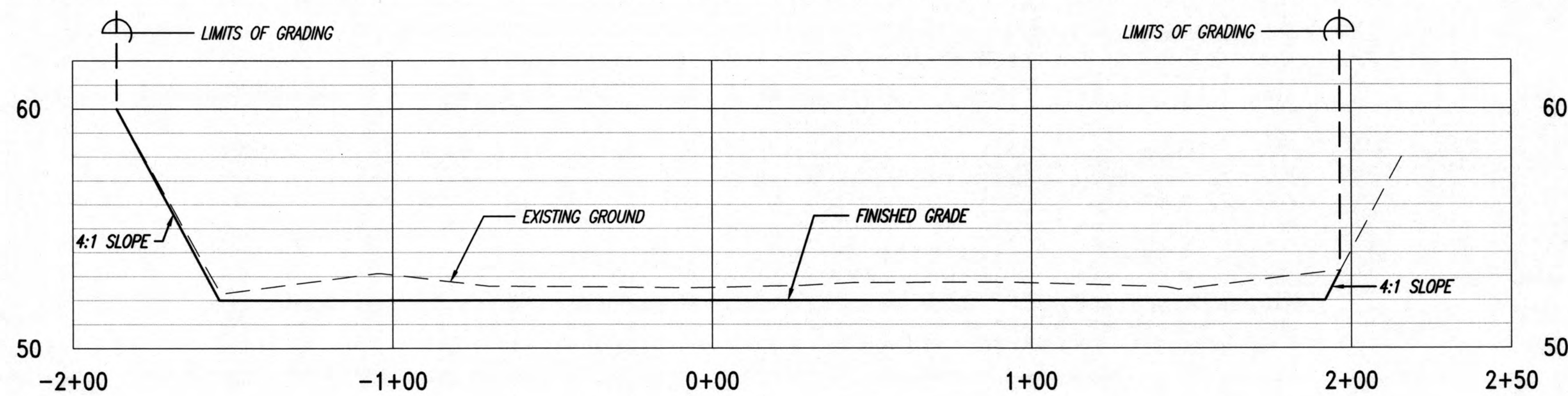

STA. 2+50

SCALES: HORIZ. 1"=30'
VERT. 1"=4'

STA. 2+50
CUT = 253.71 SQ. FT.
FILL = 4.61 SQ. FT.

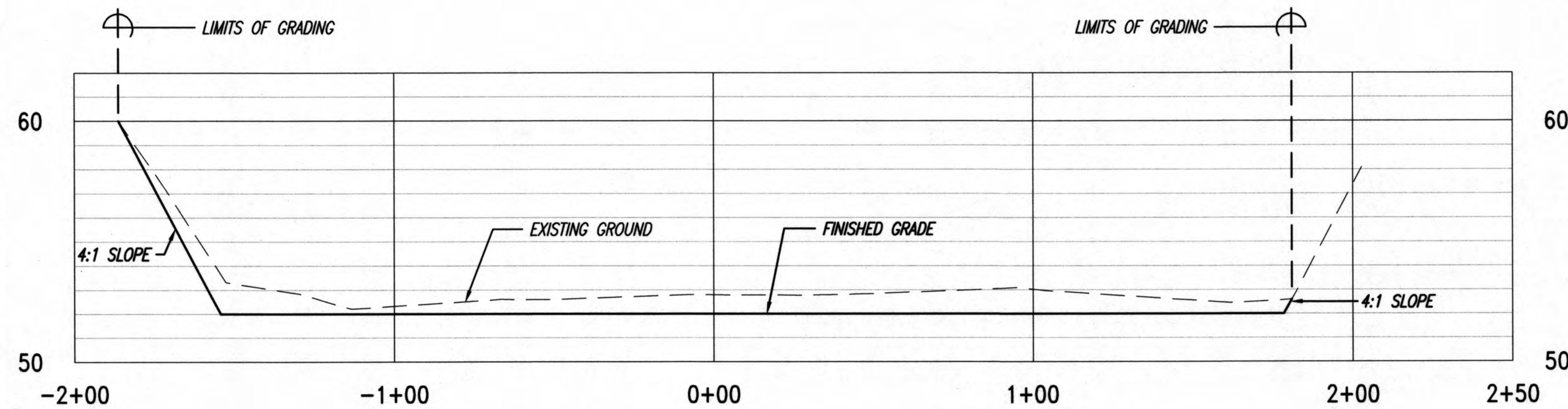

STA. 1+50

SCALES: HORIZ. 1"=30'
VERT. 1"=4'

STA. 1+50
CUT = 272.18 SQ. FT.
FILL = 0.00 SQ. FT.

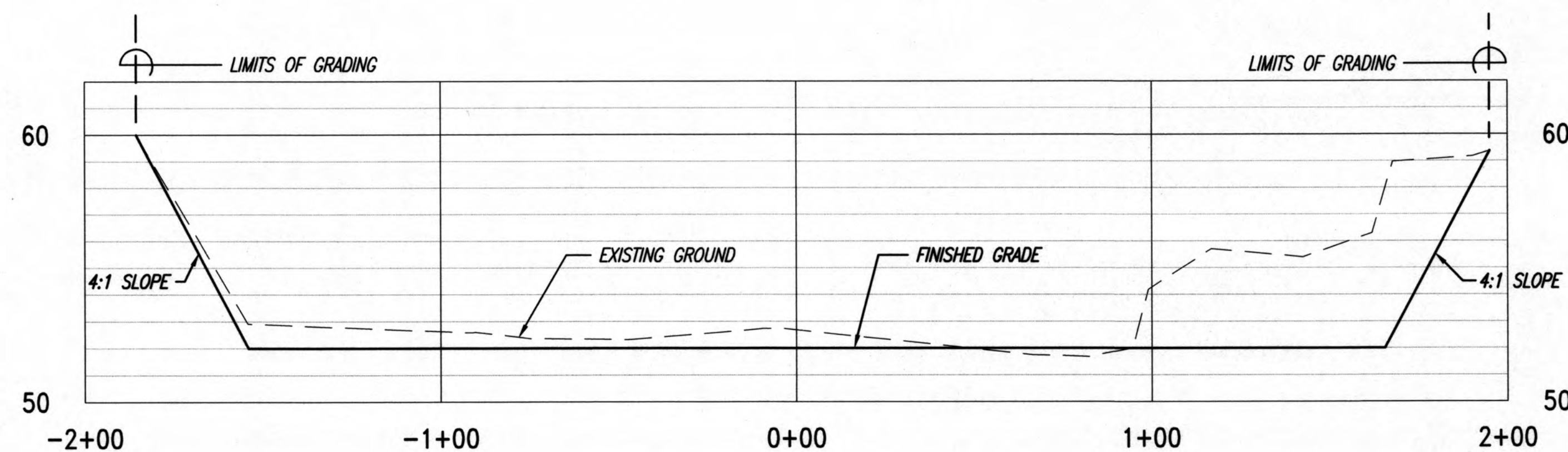

STA. 0+39.69

SCALES: HORIZ. 1"=30'
VERT. 1"=4'

STA. 0+39.69
CUT = 466.69 SQ. FT.
FILL = 8.88 SQ. FT.

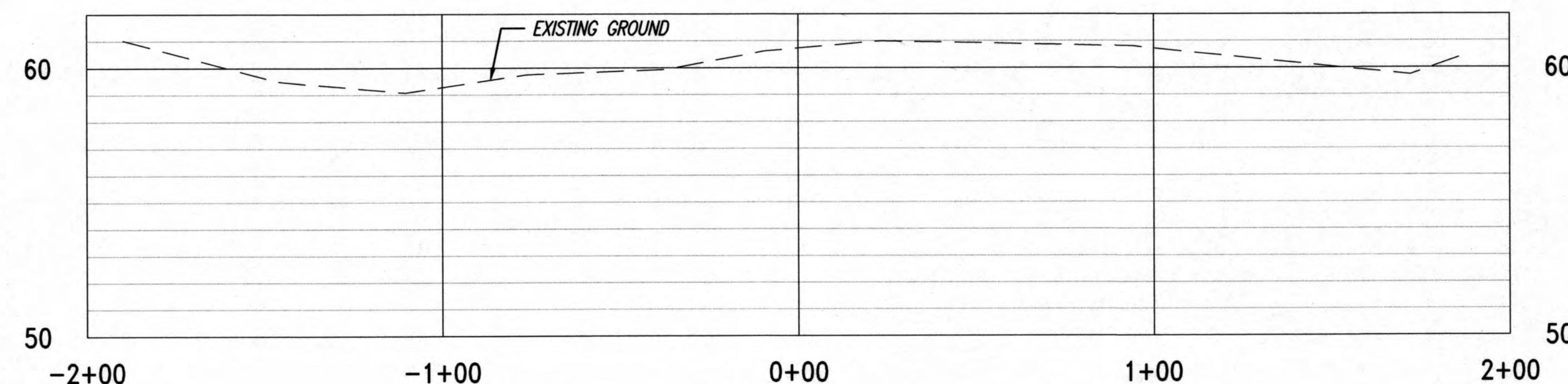

STA. 0+00

SCALES: HORIZ. 1"=30'
VERT. 1"=4'

STA. 0+00
CUT = 0.00 SQ. FT.
FILL = 0.00 SQ. FT.

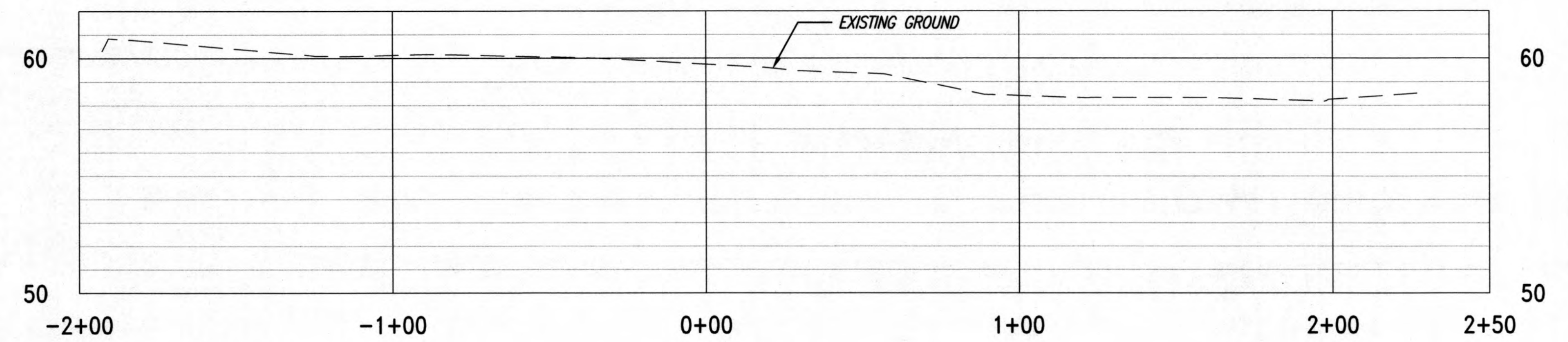

STA. 4+74.21

SCALES: HORIZ. 1"=30'
VERT. 1"=4'

STA. 4+74.21
CUT = 0.00 SQ. FT.
FILL = 0.00 SQ. FT.

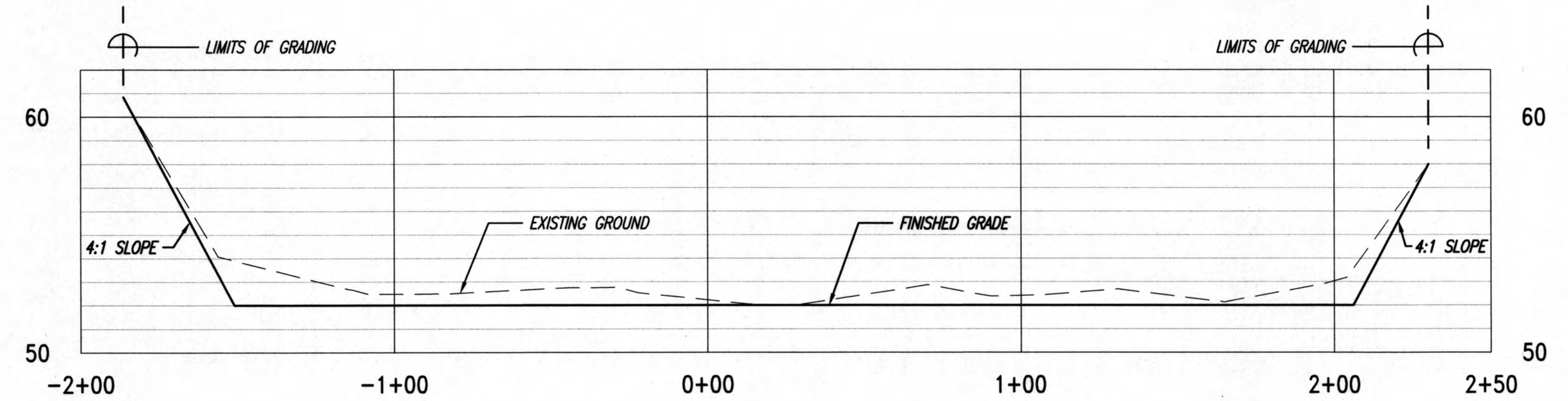

STA. 4+31.54

SCALES: HORIZ. 1"=30'
VERT. 1"=4'

STA. 4+31.54
CUT = 251.93 SQ. FT.
FILL = 0.00 SQ. FT.

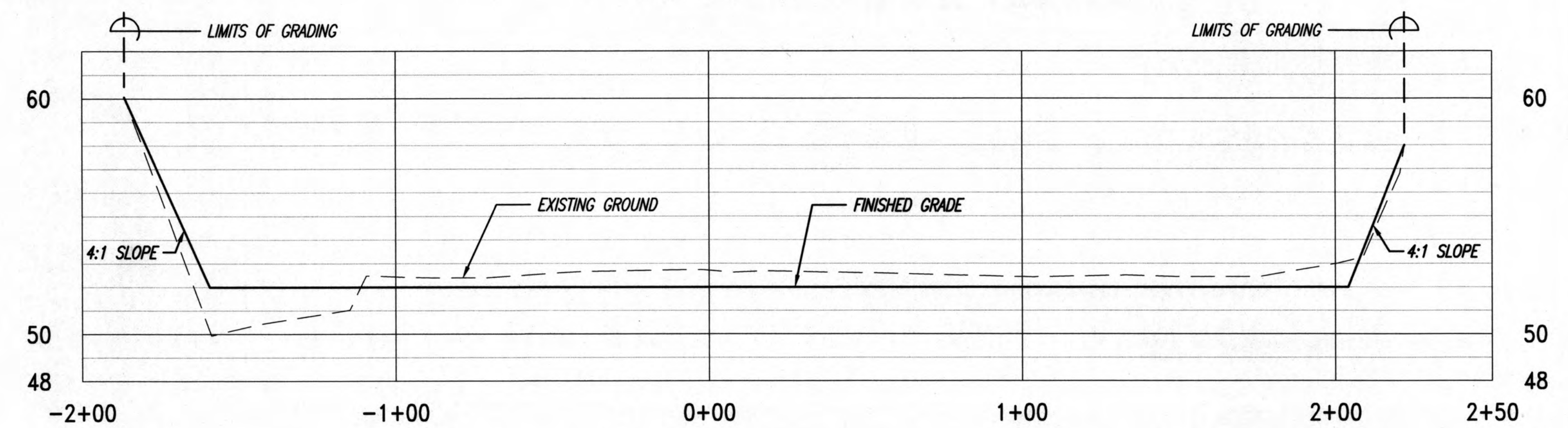

STA. 3+50

SCALES: HORIZ. 1"=30'
VERT. 1"=4'

STA. 3+50
CUT = 185.97 SQ. FT.
FILL = 116.61 SQ. FT.

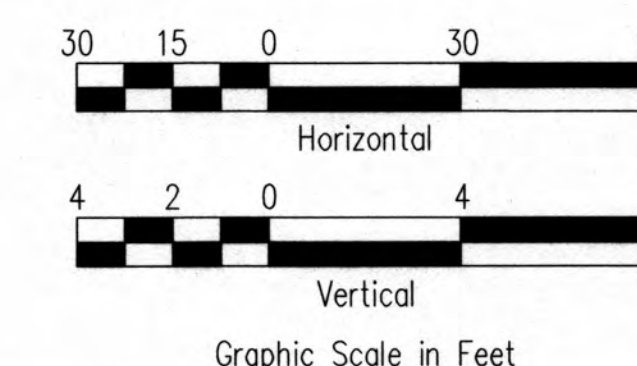

THIS WORK WAS PREPARED BY ME OR UNDER MY SUPERVISION. CONSTRUCTION OF THIS PROJECT WILL BE UNDER MY OBSERVATION. LICENSE EXPIRATION DATE: 04/30/2022

APPROVED: *Melvin J. Adams* 4/14/22
CHIEF, CIVIL ENGINEERING BRANCH, D.P.P. DATE (FOR RE-APPROVAL DUE TO TIME LAPSE)

Melvin J. Adams 5/17/18
CHIEF, CIVIL ENGINEERING BRANCH, D.P.P.

3-30-22	RE-APPROVAL DUE TO TIME LAPSE	CPE	APPROVED
Community Planning and Engineering, Inc. Engineering Design Construction Management Infrastructure Planning 1288 Queen Emma Street Honolulu, Hawaii			
EAST KAPOLEI II DETENTION BASIN RESTORATION (DPP SUBD, FILE NO. 2008/SUB-21) HONOLULU, EWA, OAHU, HAWAII OWNER & DEVELOPER: DEPARTMENT OF HAWAIIAN HOME LANDS TAX MAP KEY: 9-1-17: 110			
CROSS SECTIONS WEST DETENTION BASIN			
DRAWN BY: MFN	ENGINEER: SES	CHECKED BY: AMM	

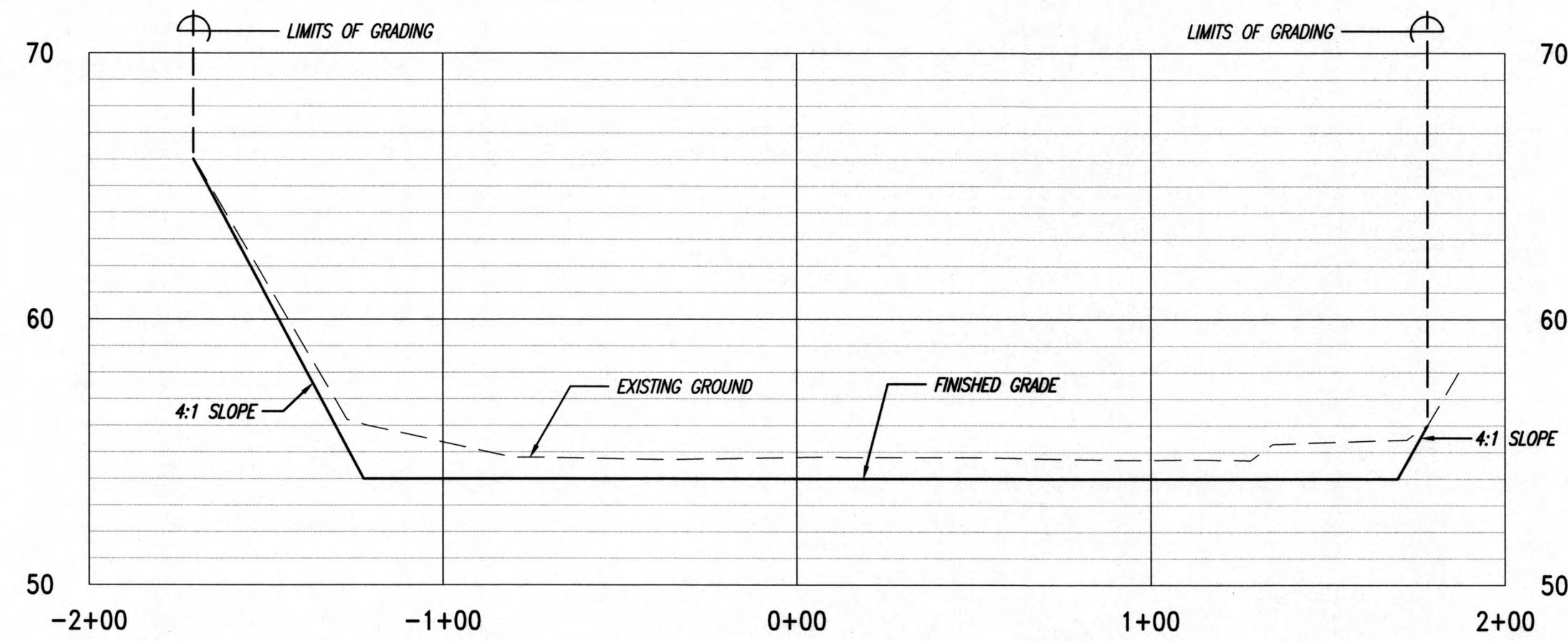

STA. 1+50

SCALES: HORIZ. 1"=30'
VERT. 1"=4'

STA. 1+50
CUT = 322.82 SQ. FT.
FILL = 0.00 SQ. FT.

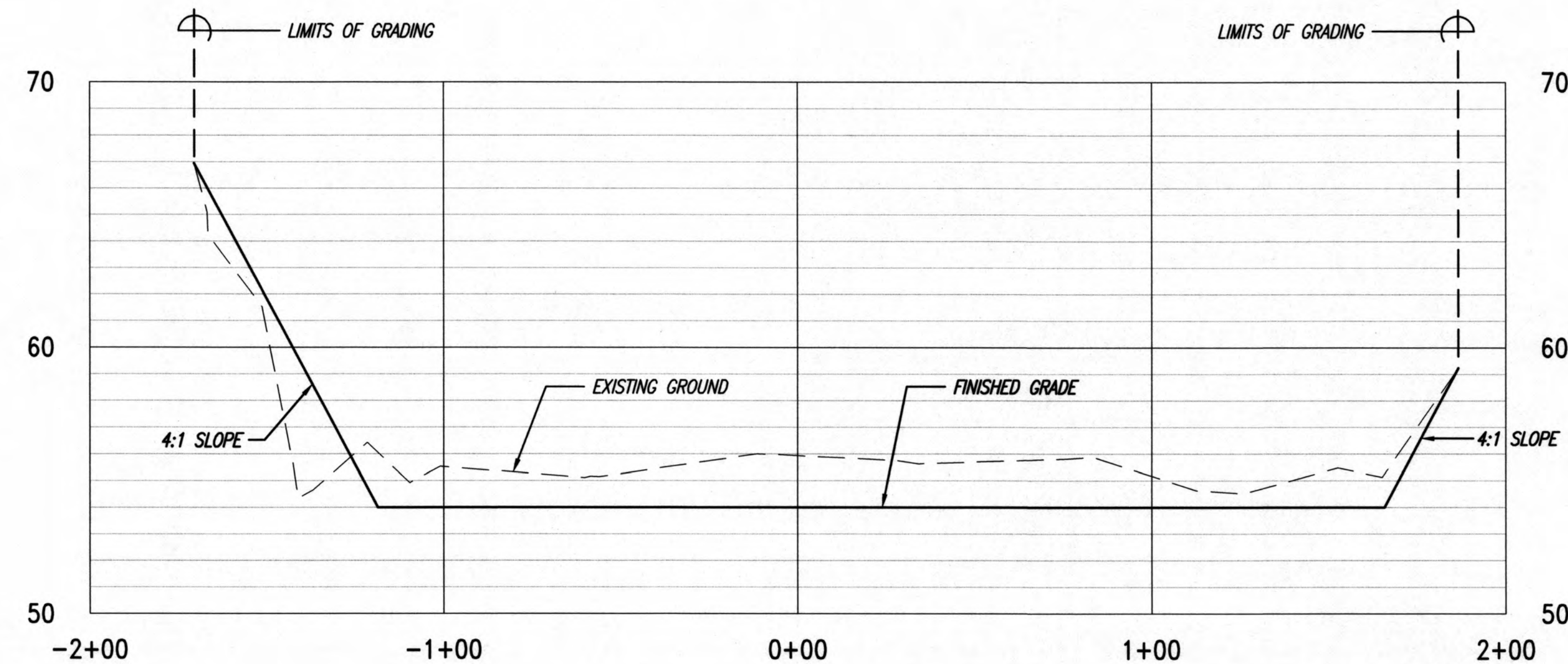

STA. 0+26.22

SCALES: HORIZ. 1"=30'
VERT. 1"=4'

STA. 0+26.22
CUT = 449.73 SQ. FT.
FILL = 55.57 SQ. FT.

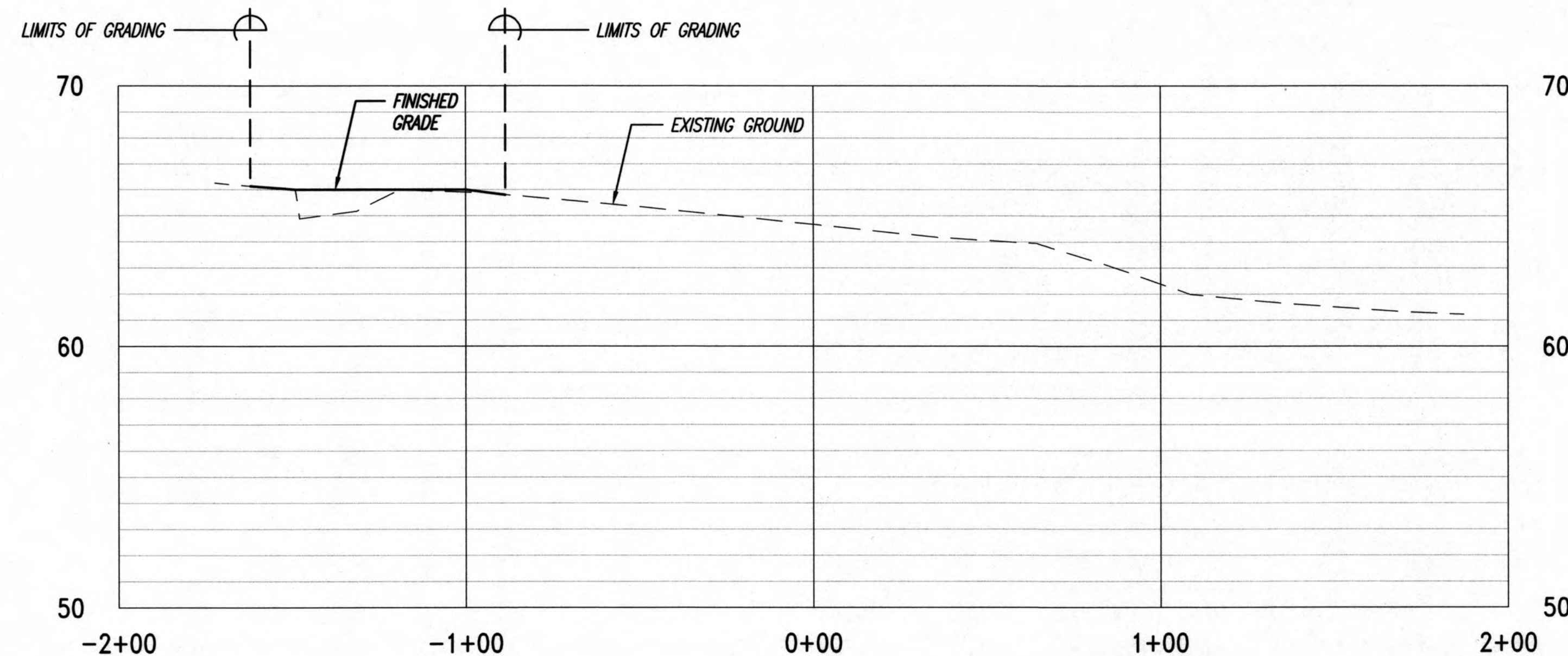

STA. 0+00

SCALES: HORIZ. 1"=30'
VERT. 1"=4'

STA. 0+00
CUT = 0.00 SQ. FT.
FILL = 29.15 SQ. FT.

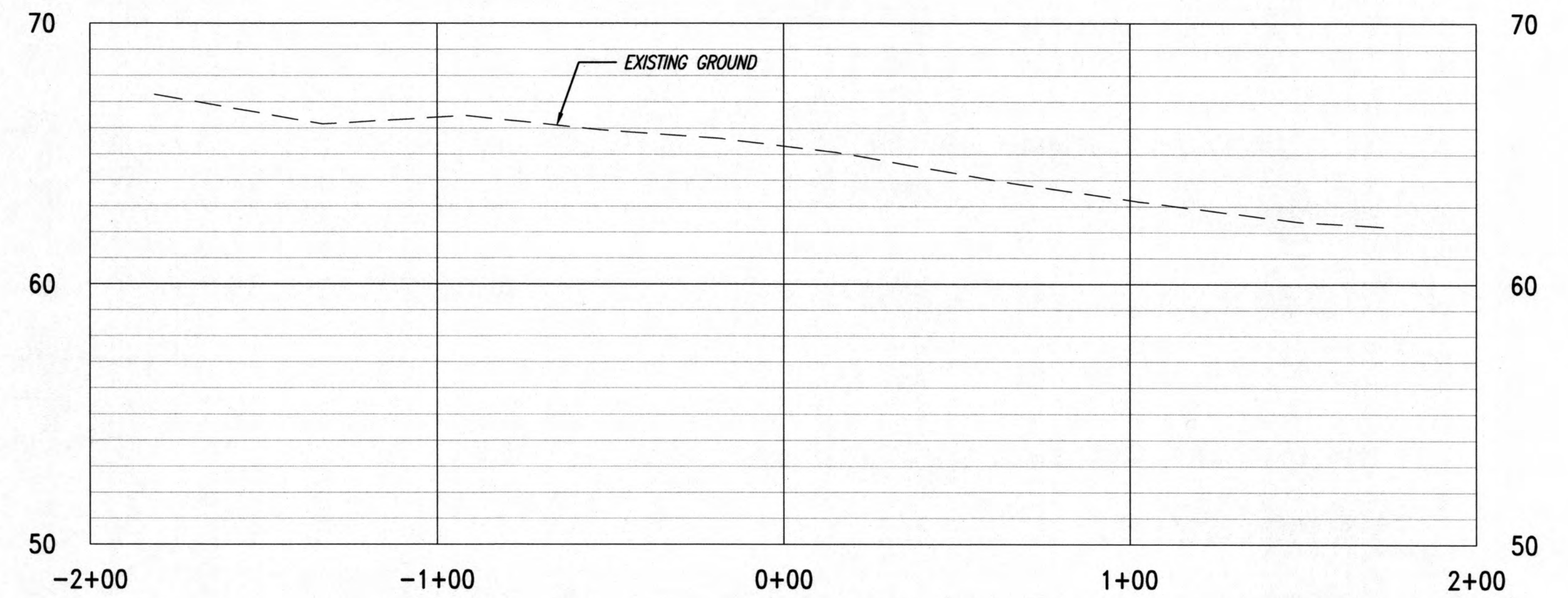

STA. 3+05.84

SCALES: HORIZ. 1"=30'
VERT. 1"=4'

STA. 4+74.21
CUT = 0.00 SQ. FT.
FILL = 0.00 SQ. FT.

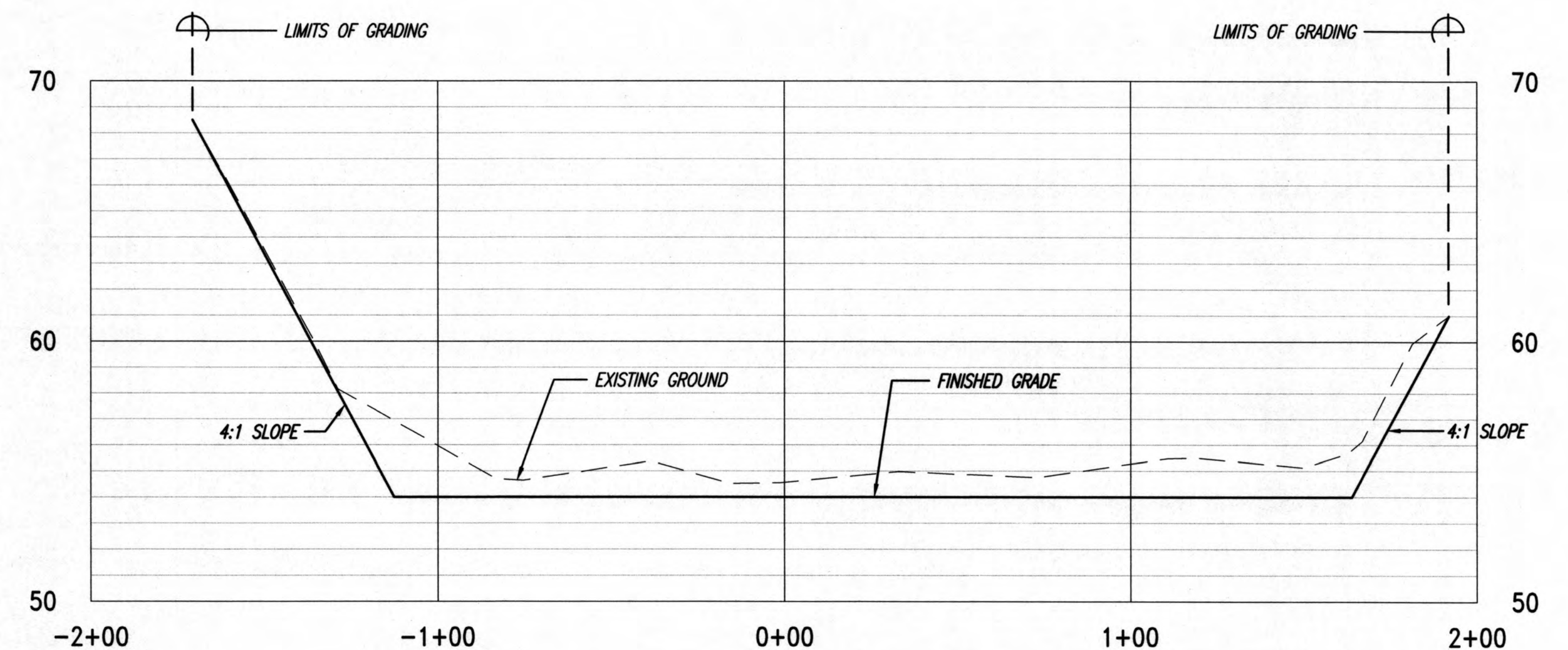

STA. 2+78.07

SCALES: HORIZ. 1"=30'
VERT. 1"=4'

STA. 2+78.07
CUT = 400.49 SQ. FT.
FILL = 0.00 SQ. FT.

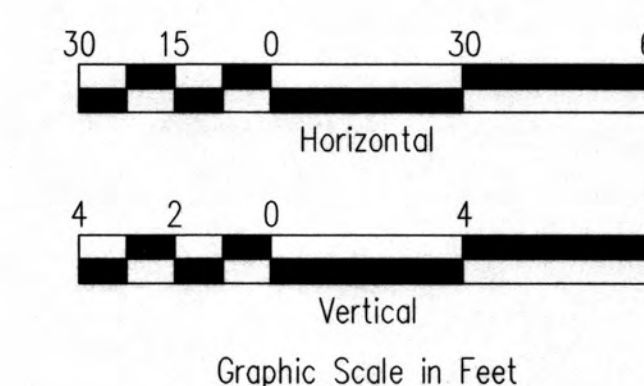

THIS WORK WAS PREPARED BY ME OR UNDER MY SUPERVISION. CONSTRUCTION OF THIS PROJECT WILL BE UNDER MY OBSERVATION. LICENSE EXPIRATION DATE: 04/30/2022

APPROVED: *Melvin S. Adams* 4/14/22
CHIEF CIVIL ENGINEERING BRANCH, DPP (FOR RE-APPROVAL DUE TO TIME LAPSE) DATE
5/17/18
CHIEF, CIVIL ENGINEERING BRANCH, DPP

3-30-22	RE-APPROVAL DUE TO TIME LAPSE	CPE	APPROVED
REVISION DATE	DESCRIPTION	MADE BY	
Community Planning and Engineering, Inc. Engineering Design Construction Management Infrastructure Planning 1288 Queen Emma Street Honolulu, Hawaii			
EAST KAPOLEI II DETENTION BASIN RESTORATION (DPP SUBD, FILE NO. 2008/SUB-21) HONOLULU, EWA, OAHU, HAWAII OWNER & DEVELOPER: DEPARTMENT OF HAWAIIAN HOME LANDS TAX MAP KEY: 9-1-17: 110			
CROSS SECTIONS EAST DETENTION BASIN			
DRAWN BY: MFN	ENGINEER: SES	CHECKED BY: AMM	

- NOTES**
1. THE EXISTING DETENTION BASINS WILL BE USED TO ADDRESS SEDIMENT TRAP REQUIREMENTS PER THE CITY AND COUNTY OF HONOLULU'S "RULES RELATING TO WATER QUALITY." REQUIRED AND AVAILABLE CAPACITY FOR EACH BASIN IS NOTED ON THIS SHEET.
 2. THE EXISTING RISERS WILL BE USED TO ADDRESS EMERGENCY OVERFLOW REQUIREMENTS PER THE "RULES RELATING TO WATER QUALITY," FOR THE EXISTING DETENTION BASINS (SEDIMENT TRAPS).
 3. REFER TO SHEET C-8 FOR EROSION AND SEDIMENT CONTROL NOTES.

- PRE-CONSTRUCTION BMP's:**
- COMPOST FILTER SOCK AT RISERS
 - INGRESS/EGRESS
 - EXISTING DETENTION BASINS TO BE USED AS SEDIMENT TRAPS
- DURING CONSTRUCTION BMP's:**
- TEMPORARY STABILIZATION
- POST-CONSTRUCTION BMP's:**
- PERMANENT STABILIZATION
- GOOD HOUSEKEEPING BMP's:**
- SEE THIS SHEET FOR EROSION CONTROL DETAILS

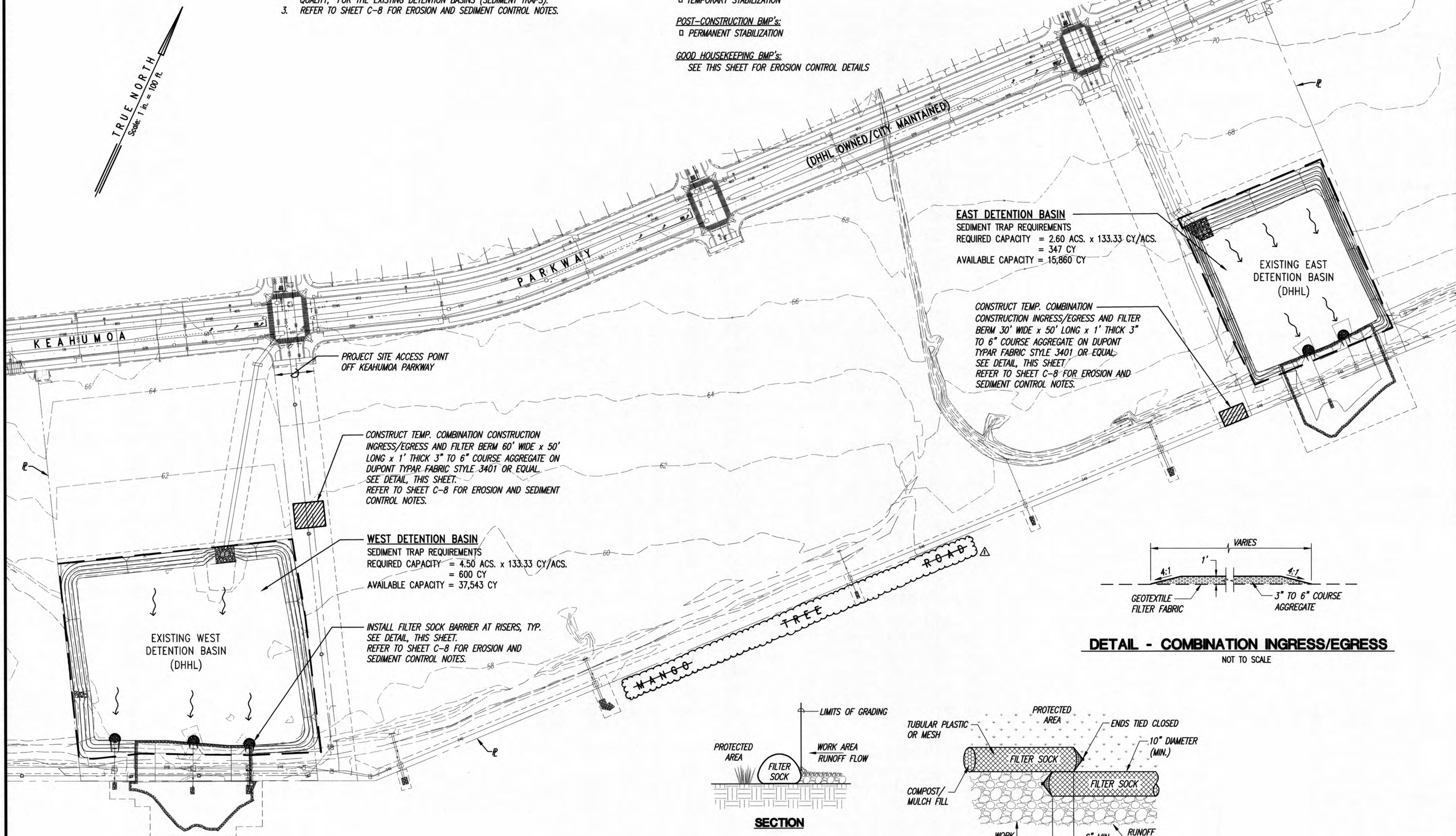
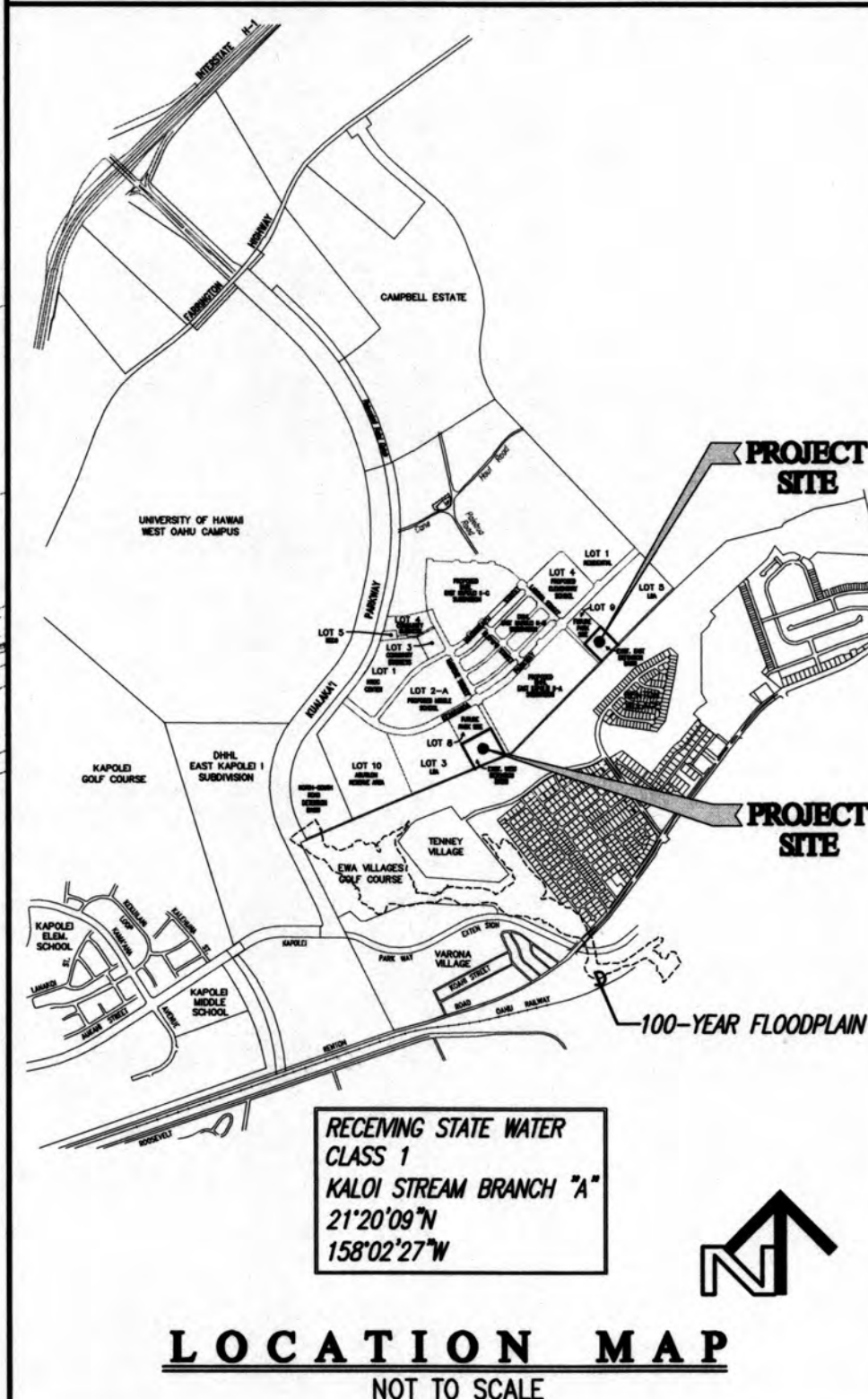

EAST DETENTION BASIN
SEDIMENT TRAP REQUIREMENTS
REQUIRED CAPACITY = 2.60 ACS. x 133.33 CY/ACS.
= 347 CY
AVAILABLE CAPACITY = 15,860 CY

CONSTRUCT TEMP. COMBINATION
CONSTRUCTION INGRESS/EGRESS AND FILTER
BERM 30' WIDE x 50' LONG x 1' THICK 3"
TO 6" COURSE AGGREGATE ON DUPONT
TYPAR FABRIC STYLE 3401 OR EQUAL.
SEE DETAIL, THIS SHEET.
REFER TO SHEET C-8 FOR EROSION AND
SEDIMENT CONTROL NOTES.

CONSTRUCT TEMP. COMBINATION CONSTRUCTION
INGRESS/EGRESS AND FILTER BERM 60' WIDE x 50'
LONG x 1' THICK 3" TO 6" COURSE AGGREGATE ON
DUPONT TYPAR FABRIC STYLE 3401 OR EQUAL.
SEE DETAIL, THIS SHEET.
REFER TO SHEET C-8 FOR EROSION AND SEDIMENT
CONTROL NOTES.

WEST DETENTION BASIN
SEDIMENT TRAP REQUIREMENTS
REQUIRED CAPACITY = 4.50 ACS. x 133.33 CY/ACS.
= 600 CY
AVAILABLE CAPACITY = 37,543 CY

INSTALL FILTER SOCK BARRIER AT RISERS, TYP.
SEE DETAIL, THIS SHEET.
REFER TO SHEET C-8 FOR EROSION AND
SEDIMENT CONTROL NOTES.

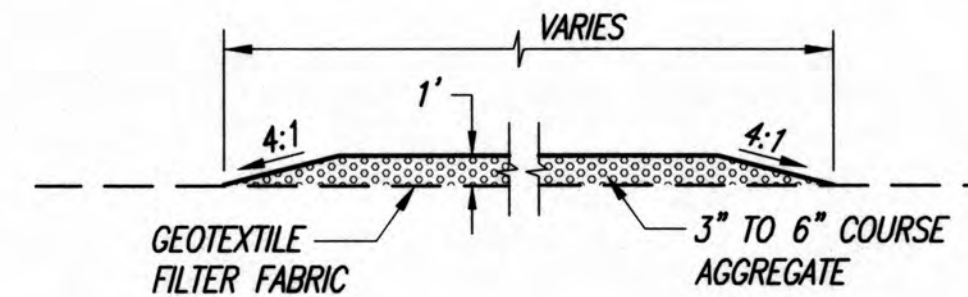

DETAIL - COMBINATION INGRESS/EGRESS
NOT TO SCALE

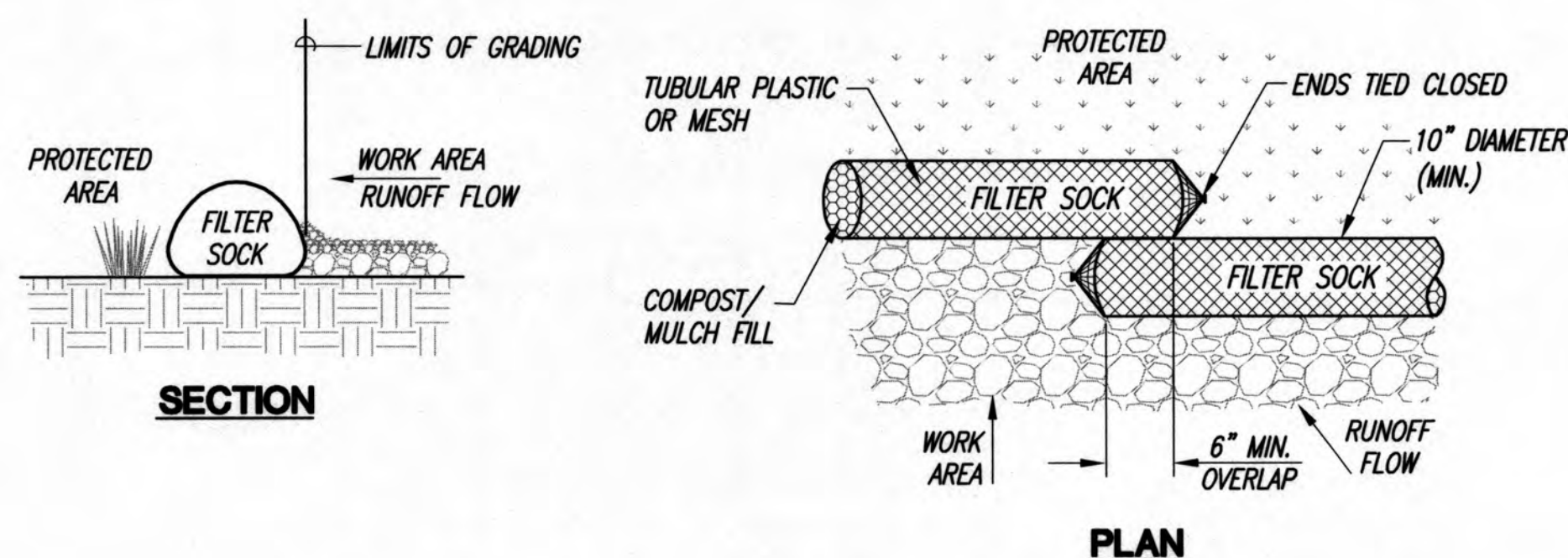

DETAIL - FILTER SOCK
NOT TO SCALE

EROSION AND SEDIMENT CONTROL PLAN (CATEGORY 5)

SCALE: 1" = 100'

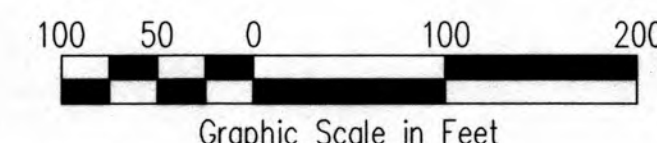

THIS WORK WAS PREPARED BY
ME OR UNDER MY SUPERVISION
CONSTRUCTION OF THIS PROJECT
WILL BE UNDER MY OBSERVATION
LICENSE EXPIRATION DATE: 04/30/2022

REVISION DATE	DESCRIPTION	MADE BY	APPROVED
3-30-22	RE-APPROVAL DUE TO TIME LAPSE	CPE	
Community Planning and Engineering, Inc. Engineering Design Construction Management Infrastructure Planning 1286 Queen Emma Street Honolulu, Hawaii			
EAST KAPOLEI II DETENTION BASIN RESTORATION (DPP SUBD, FILE NO. 2008/SUB-21) HONOLULU, EWA, OAHU, HAWAII OWNER & DEVELOPER: DEPARTMENT OF HAWAIIAN HOME LANDS TAX MAP KEY: 9-1-17: 110			
EROSION AND SEDIMENT CONTROL PLAN			
DRAWN BY: MFN	ENGINEER: SES	CHECKED BY: AMM	
APPROVED: <i>Melissa S. Adams</i> 4/11/22 CHIEF, CIVIL ENGINEERING BRANCH D.P.P. (FOR RE-APPROVAL DUE TO TIME LAPSE) DATE			
APPROVED: <i>Melissa S. Adams</i> 5/17/18 CHIEF, CIVIL ENGINEERING BRANCH D.P.P. DATE			

- NOTES**
1. THE EXISTING DETENTION BASINS WILL BE USED TO ADDRESS SEDIMENT TRAP REQUIREMENTS PER THE CITY AND COUNTY OF HONOLULU'S "RULES RELATING TO WATER QUALITY." REQUIRED AND AVAILABLE CAPACITY FOR EACH BASIN IS NOTED ON THIS SHEET.
 2. THE EXISTING RISERS WILL BE USED TO ADDRESS EMERGENCY OVERFLOW REQUIREMENTS PER THE "RULES RELATING TO WATER QUALITY," FOR THE EXISTING DETENTION BASINS (SEDIMENT TRAPS).
 3. REFER TO SHEET C-8 FOR EROSION AND SEDIMENT CONTROL NOTES.

- PRE-CONSTRUCTION BMP's:**
- COMPOST FILTER SOCK AT RISERS
 - INGRESS/EGRESS
 - EXISTING DETENTION BASINS TO BE USED AS SEDIMENT TRAPS
- DURING CONSTRUCTION BMP's:**
- TEMPORARY STABILIZATION
- POST-CONSTRUCTION BMP's:**
- PERMANENT STABILIZATION
- GOOD HOUSEKEEPING BMP's:**
- SEE THIS SHEET FOR EROSION CONTROL DETAILS

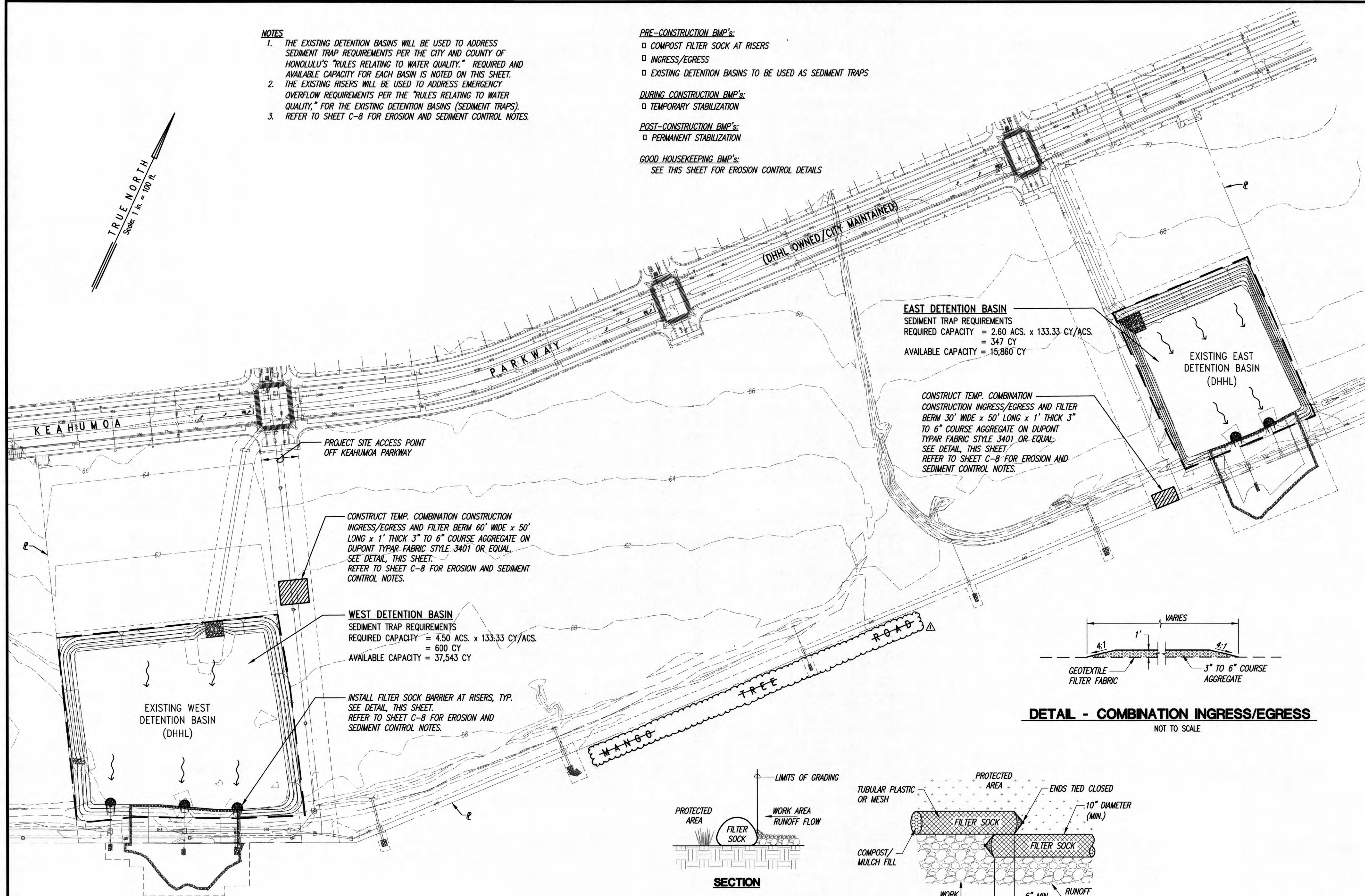

EAST DETENTION BASIN
SEDIMENT TRAP REQUIREMENTS
REQUIRED CAPACITY = 2.60 ACS. x 133.33 CY/ACS.
= 347 CY
AVAILABLE CAPACITY = 15,860 CY

CONSTRUCT TEMP. COMBINATION
CONSTRUCTION INGRESS/EGRESS AND FILTER
BERM 30' WIDE x 50' LONG x 1' THICK 3"
TO 6" COURSE AGGREGATE ON DUPONT
TYPAR FABRIC STYLE 3401 OR EQUAL.
SEE DETAIL, THIS SHEET.
REFER TO SHEET C-8 FOR EROSION AND
SEDIMENT CONTROL NOTES.

CONSTRUCT TEMP. COMBINATION CONSTRUCTION
INGRESS/EGRESS AND FILTER BERM 60' WIDE x 50'
LONG x 1' THICK 3" TO 6" COURSE AGGREGATE ON
DUPONT TYPAR FABRIC STYLE 3401 OR EQUAL.
SEE DETAIL, THIS SHEET.
REFER TO SHEET C-8 FOR EROSION AND SEDIMENT
CONTROL NOTES.

WEST DETENTION BASIN
SEDIMENT TRAP REQUIREMENTS
REQUIRED CAPACITY = 4.50 ACS. x 133.33 CY/ACS.
= 600 CY
AVAILABLE CAPACITY = 37,543 CY

INSTALL FILTER SOCK BARRIER AT RISERS, TYP.
SEE DETAIL, THIS SHEET.
REFER TO SHEET C-8 FOR EROSION AND
SEDIMENT CONTROL NOTES.

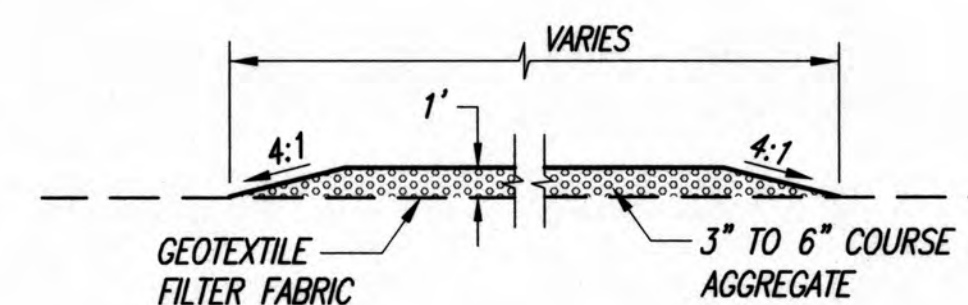

DETAIL - COMBINATION INGRESS/EGRESS
NOT TO SCALE

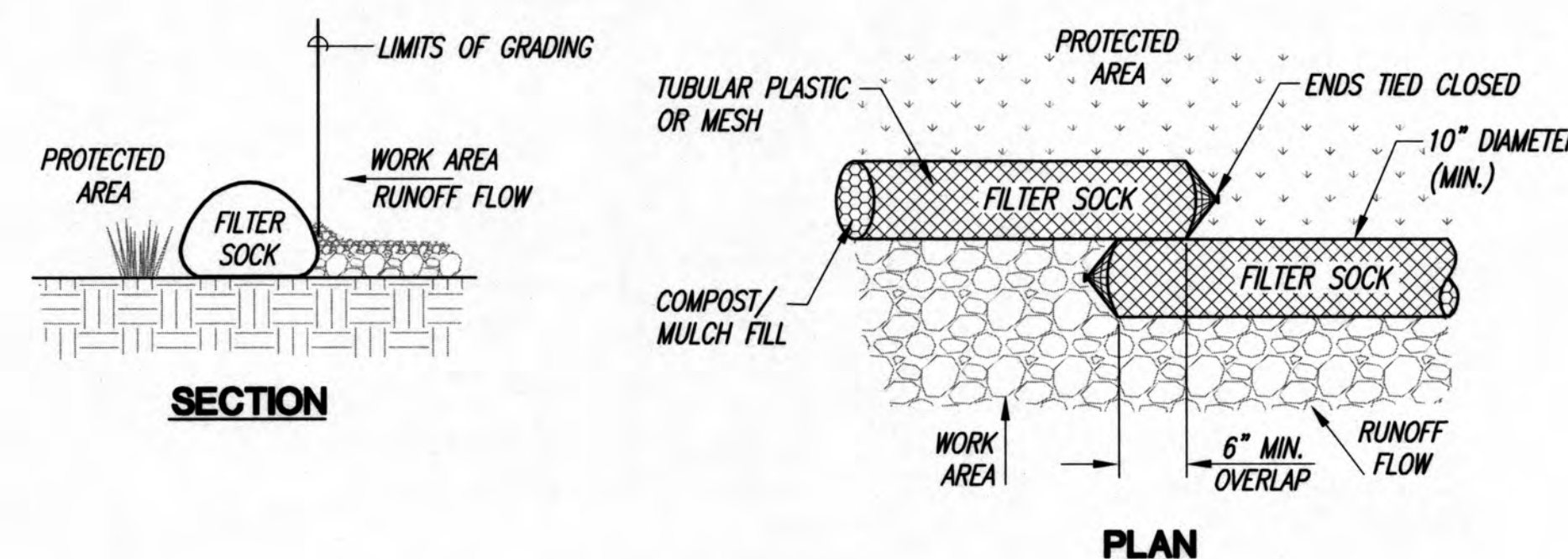

DETAIL - FILTER SOCK
NOT TO SCALE

EROSION AND SEDIMENT CONTROL PLAN (CATEGORY 5)

SCALE: 1" = 100'

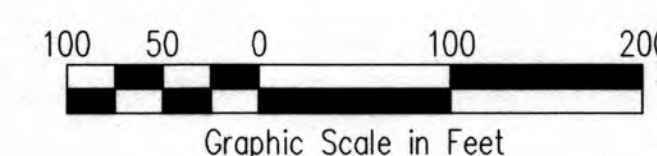

THIS WORK WAS PREPARED BY
ME OR UNDER MY SUPERVISION.
CONSTRUCTION OF THIS PROJECT
WILL BE UNDER MY OBSERVATION.
LICENSE EXPIRATION DATE: 04/30/2022

APPROVED: *[Signature]* DATE: 5/17/18
CHIEF, CIVIL ENGINEERING BRANCH D.P.P.
(FOR RE-APPROVAL DUE TO TIME LAPSE)

CHIEF, CIVIL ENGINEERING BRANCH, D.P.P.

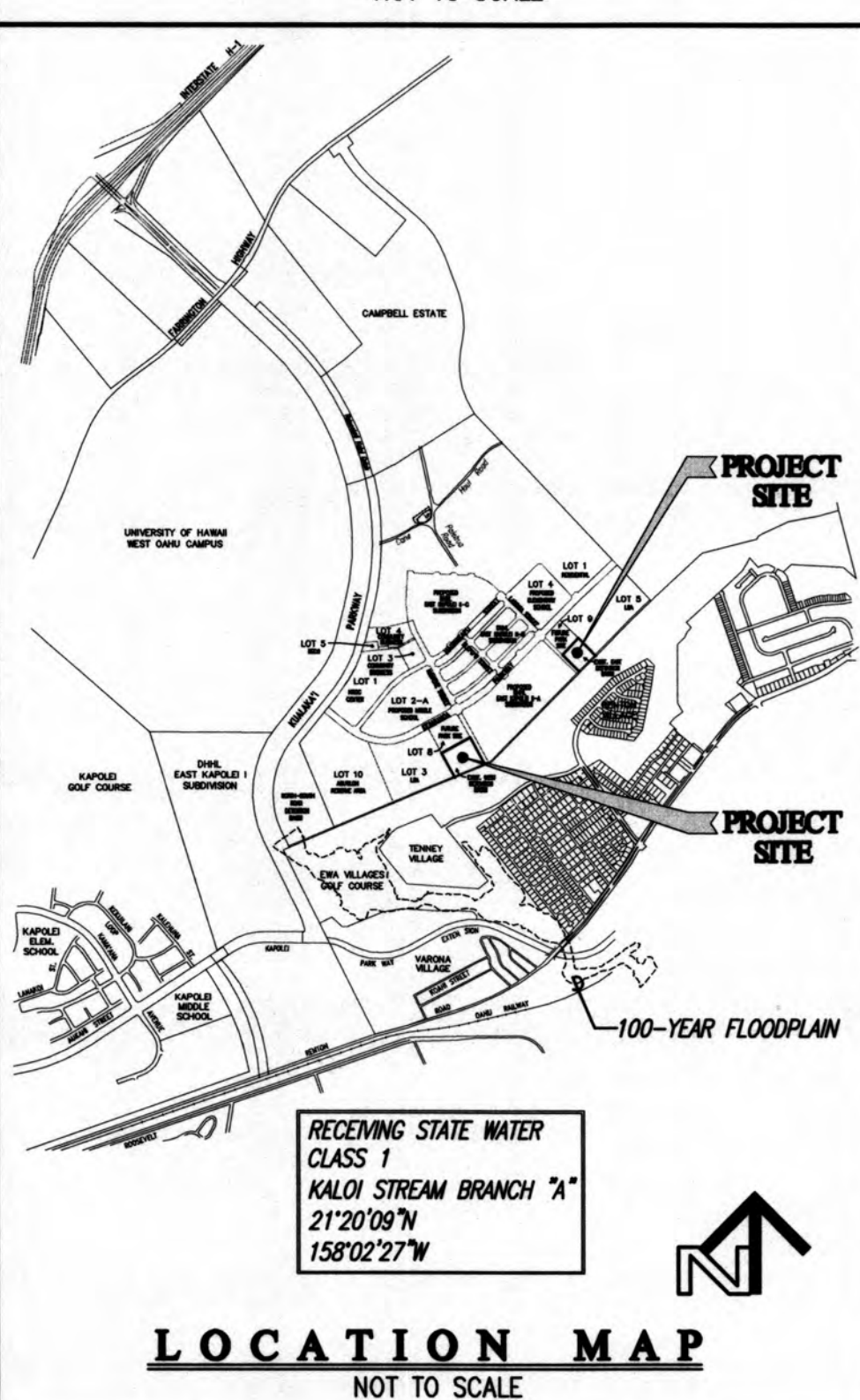

LEGEND

- EXISTING GRADE
- SURFACE WATER FLOW
- LIMITS OF GRADING AND DISTURBANCE
- FILTER SOCK BARRIER
- CONSTRUCTION EGRESS/INGRESS AND FILTER BERM

REVISION DATE	DESCRIPTION	MADE BY	APPROVED
3-30-22	RE-APPROVAL DUE TO TIME LAPSE	CPE	
Community Planning and Engineering, Inc.			
Engineering Design Construction Management Infrastructure Planning			
1288 Queen Emma Street Honolulu, Hawaii			
EAST KAPOLEI II			
DETENTION BASIN RESTORATION			
(DPP SUBD, FILE NO. 2008/SUB-21)			
HONOLULU, EWA, OAHU, HAWAII			
OWNER & DEVELOPER: DEPARTMENT OF HAWAIIAN HOME LANDS			
TAX MAP KEY: 9-1-17: 110			
EROSION AND SEDIMENT CONTROL PLAN			
DRAWN BY: MFN	ENGINEER: SES	CHECKED BY: AMM	
APPROVED: <i>[Signature]</i> DATE: 5/17/18			
CHIEF, CIVIL ENGINEERING BRANCH D.P.P.			
(FOR RE-APPROVAL DUE TO TIME LAPSE)			
CHIEF, CIVIL ENGINEERING BRANCH, D.P.P.			

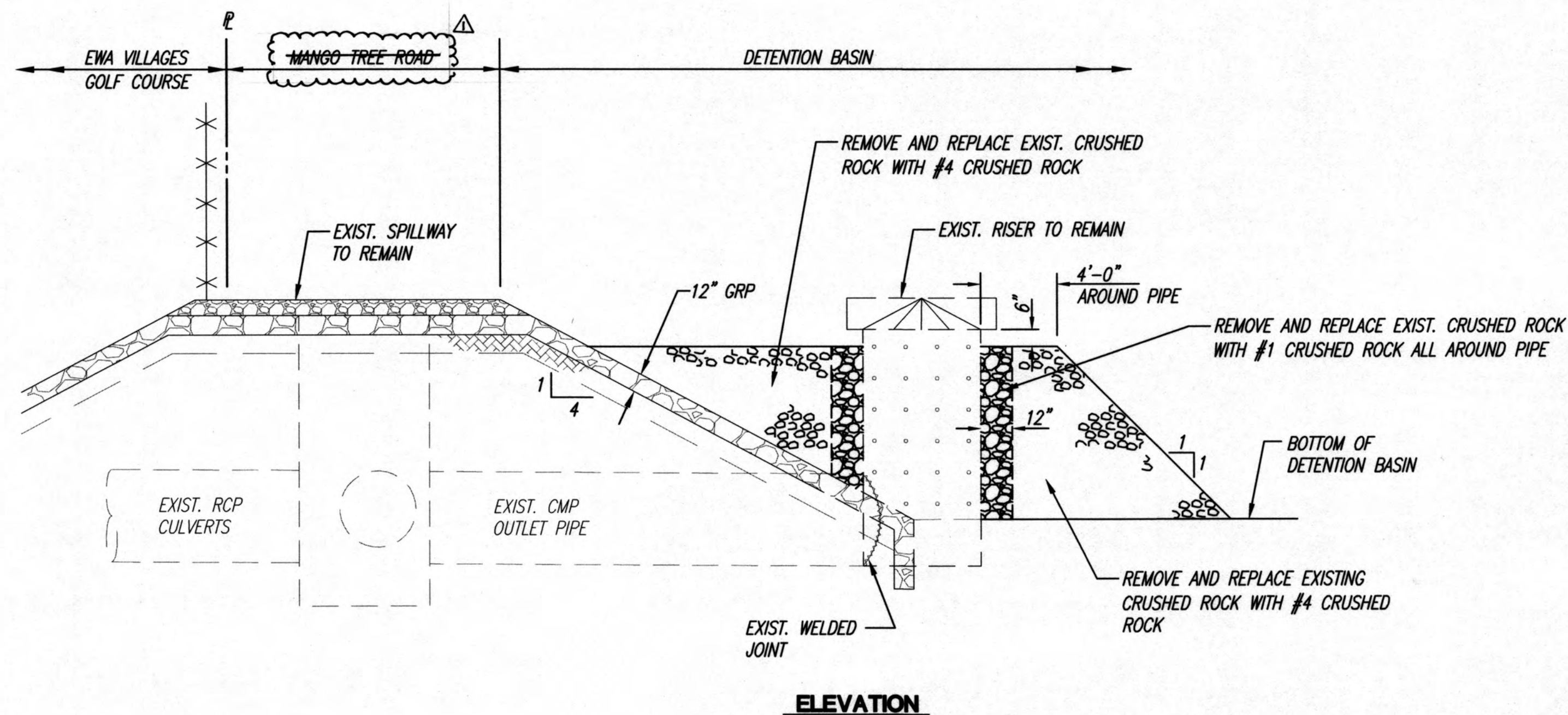

DETAIL - OUTLET RISER RESTORATION
NOT TO SCALE

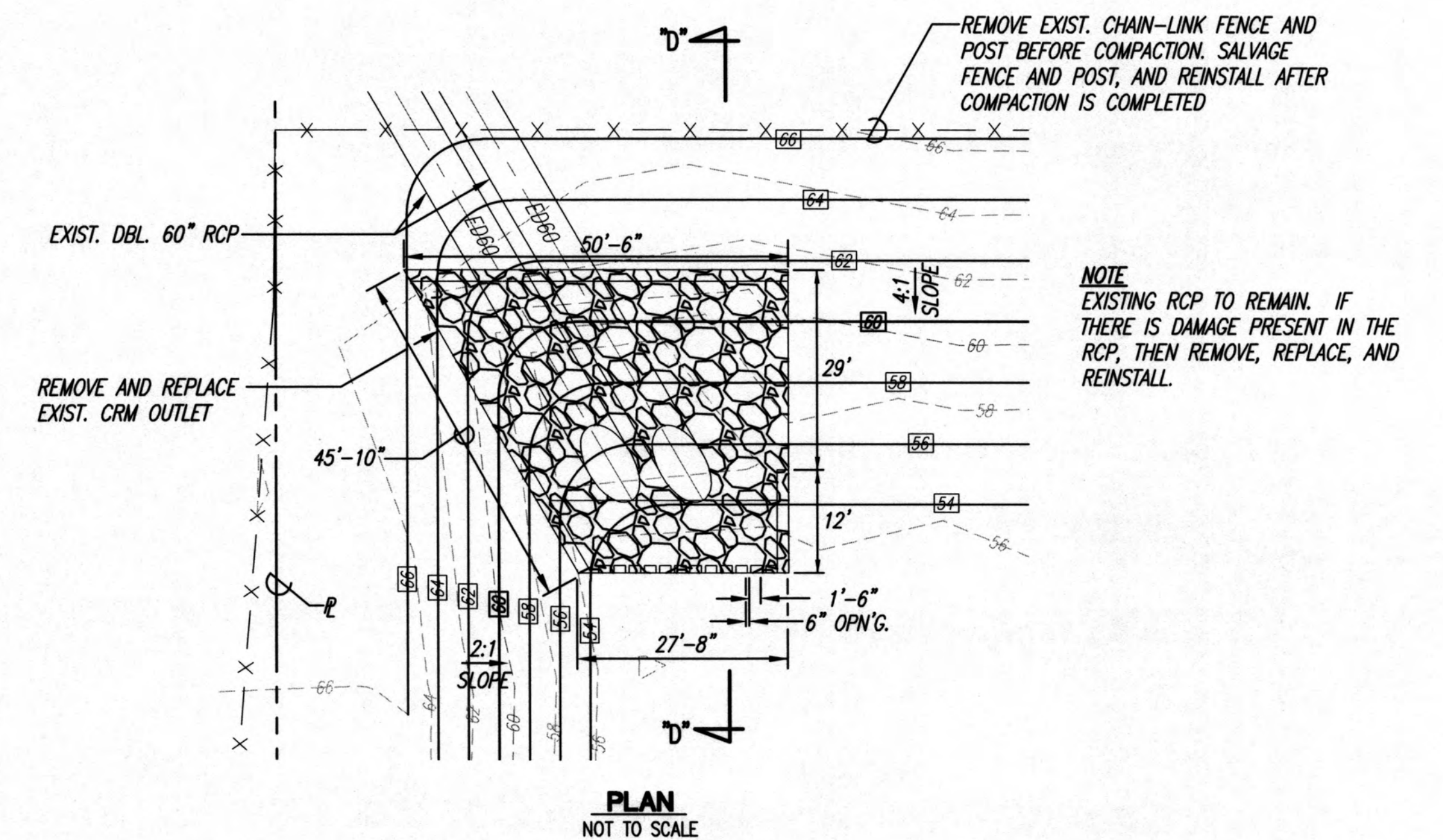
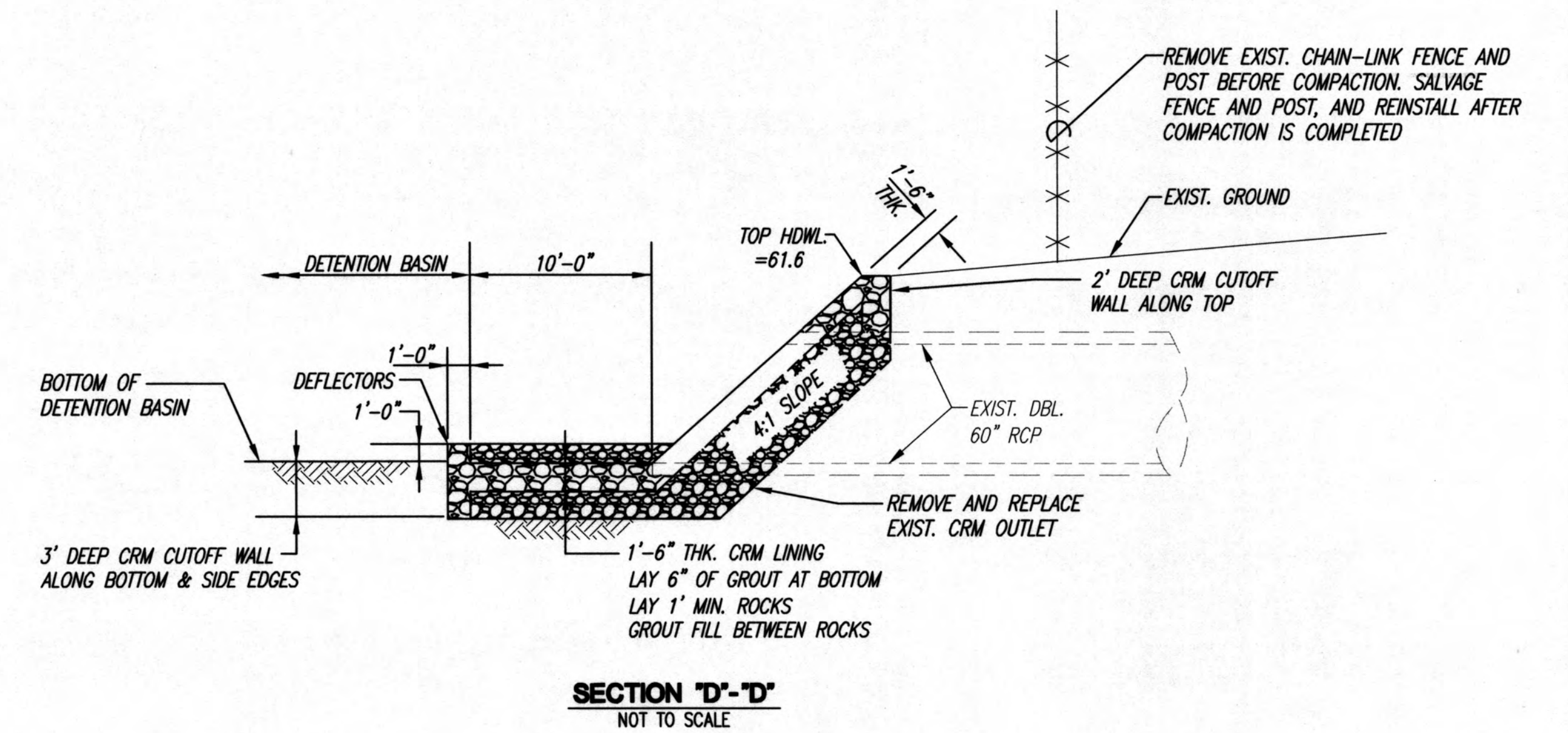

DETAIL - CRM OUTLET FOR EAST DETENTION BASIN



THIS WORK WAS PREPARED BY
ME OR UNDER MY SUPERVISION
CONSTRUCTION OF THIS PROJECT
WILL BE UNDER MY OBSERVATION
LICENSE EXPIRATION DATE: 04/30/2022

REVISION DATE	DESCRIPTION	MADE BY	APPROVED
9-30-22	RE-APPROVAL DUE TO TIME LAPSE	CPE	

Community Planning and Engineering, Inc.
Engineering Design | Construction Management | Infrastructure Planning
1286 Queen Emma Street Honolulu, Hawaii

EAST KAPOLEI II
DETENTION BASIN RESTORATION
(DPP SUBD, FILE NO. 2008/SUB-21)
HONOLULU, EWA, OAHU, HAWAII

OWNER & DEVELOPER: DEPARTMENT OF HAWAIIAN HOME LANDS
TAX MAP KEY: 9-1-17: 110

MISCELLANEOUS DETAILS

DRAWN BY: MFN	ENGINEER: SES	CHECKED BY: AMM
---------------	---------------	-----------------

APPROVED: *Melani Selahuna* 4/4/22
CHIEF, CIVIL ENGINEERING BRANCH, D.P.P.
(FOR RE-APPROVAL DUE TO TIME LAPSE)
DATE: 5/17/18
Melani Selahuna
CHIEF, CIVIL ENGINEERING BRANCH, D.P.P.